

# DIALITE Vision LED

## 2 x 17 Watt



Made in Germany

Information

### Vision LED

The high power LED lights. High contrast, flickerfree and cool.



### Two LED Lamps

2 x 17 Watt exchangeable LED lamps in parallel order.

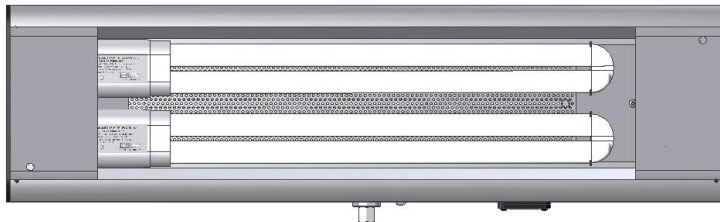

### SpectroLED TP

Two LED lines per lamp, capsuled in safety-hardglasstubes.



### Highest Contrast

The matted cover of the LED lamps with special semi transparent glass provides diffuse as well as very contrasty LED light.

### LED Power/ Luminous flux

2 x 17 Watt – 4,200 lumen

### Energy Saving

The low connection power of the LED lamps alone can only be limited counted as energy saving in comparison to compact fluorescent lamps. The striking point is the luminous flux (lumen) that creates the respective illuminance.

Depending on the light type the LED energy saving can be calculated with 20-30%, with same illuminance of course.

# DIALITE Vision LED

## 2 x 17 Watt



Made in Germany

Information

### Diffuse and contrasty LED light

The hardglass tubes of the LED lamps are consisting of matted glass. This unique making provides an even light distribution and same time high contrast!

Like this the light power is used to almost 100% capacity. No matt perspex diffusors are needed that are considerably reducing illuminance and contrast. Also the energy efficiency is no more coherent.

### SpectroLED TP Lamp Service

The LED lamps are socketed and thus exchangeable! As well as with fluorescent lamps the LED can be exchanged easily for a different colour of light or for service without expenditure on repair.

Thus these unique lights do not only have an economic but also an ecologic aspect. Only the LED lamp has to be disposed, not the whole luminaire itself.

### Lamps Colours of Light Mixed Light

Essential for the vision task is the colour of light of the LED.

At choice are daylight 6,500 Kelvin, neutral white 4,000K and incandescent yellow 3,000K. All DIALITE reflectors have two parallel lamp positions. If two lamps of different colours of light are used the task can be illuminated in alternate or mixed colours. Thus it is possible to work with three different colours of light.

### Two Switches

Both lamps are separately switchable for full or half lighting power.

### electronic

Flimmer-and flickerfree operation by a converter for each LED lamp.

### Illuminance at a distance of 400mm (16")

7,000 Lux at 2 x 17 Watt / 3,500 Lux at 1 x 17 Watt

### Cool Light

The slits at the topside of the reflector are unique for LED lights. The **heat** of the LED is exhausted and thus provides a **cool** reflector. Good for comfortable temperatures in the area of the head.

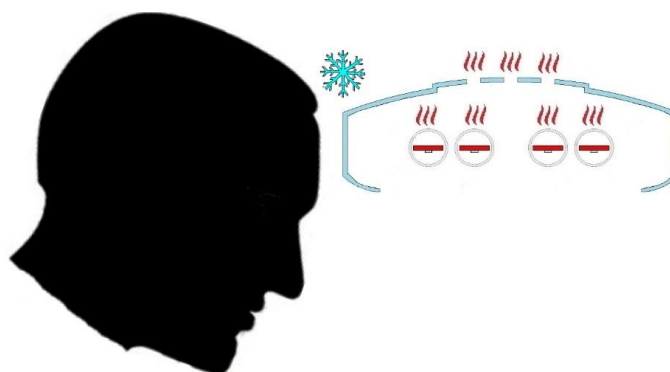

### Reflector/ Dimensions

Solid aluminium profile with resistant silvergry epoxy coating. Inner reflector anodized aluminium and stainless steel. Topside slits for heat dissipation

# DIALITE Vision LED

## 2 x 17 Watt



Made in Germany

Information

**MULTIFLEX  
Spring  
Balanced  
Articulated  
Arms**

At choice are the classic double spring arm with wide vertical and horizontal movement range as well as the compact single spring arm for short deflection. Connected by sturdy joints made of high-grade steel profiles with silvergrey epoxy coating on top, anthracite on rear side.

**Multiflexible  
Movement**

All arms are feathery adjustable. Alignment of reflector by parallel movement.

**Multiflexible  
Use**

The flexibility of all arms can be inhibited or blocked on demand, like a memory. For that purpose each arm has a wing nut on the rear side. Thus the light can be fixed or used flexible.

**Spring Arm  
Retention Force**

The springs of the horizontal and vertical arms can be readjusted if necessary.

**Dimensions**

**Double Spring Arm**

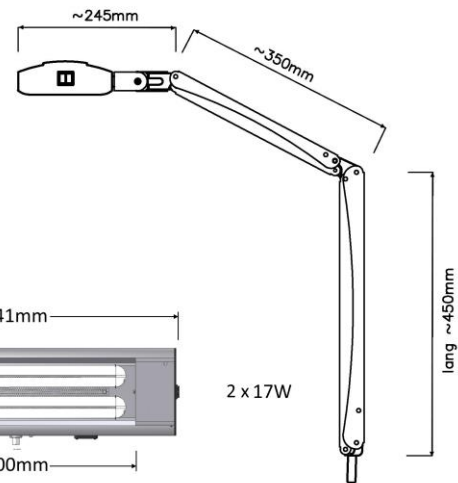

**Single Spring Arm**

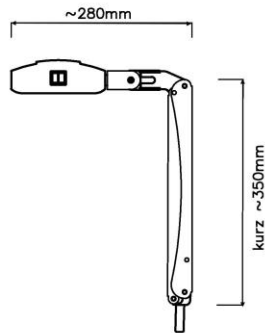

**Reflector  
at 3D Joint**

Spring arm and reflector are connected by a 3D headjoint for free movement and adjustment of the reflector over 3 axes.

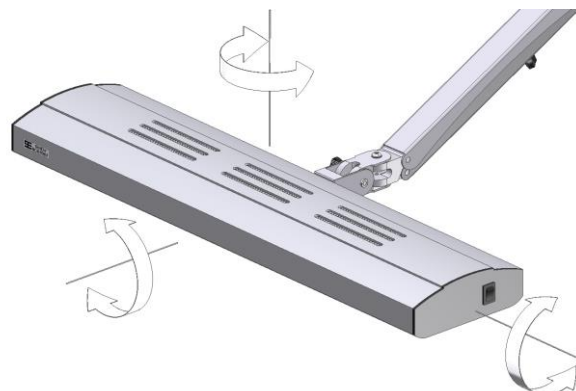

# DIALITE Vision LED

## 2 x 17 Watt



Made in Germany

Information

<b>Weight</b>	Abt. 3,500g
<b>Power</b>	240-220V/50Hz. Power cord 3-wire grounded type: 2,500mm ( 8ft ) long, with removable plug. Degree/class of protection: IP 20 / I. Electromagnetic compatibility following the EU norms.

### Accessories for mounting

**Mountings** There is a great variety of mountings for the DIALITE Vision lights:  
The installation is easily done, just put the stud at the bottom of the light in one of the mountings shown – and ready!



**TKS-VIS**  
Desk clamp for table boards from 10 to 80mm.  
Weight 650g.  
Black/anthracite.



**T**  
Desk insert mount for table boards 10-40mm.  
alu



**S 10-VIS**  
Heavy base, diameter 285mm.  
Weight 10,000g.  
Black/anthracite.



**C-VIS**  
Screw-down desk mount, diameter 60mm. Height 50mm.  
Black.



**B-VIS**  
Wall mount, black/anthracite.